

## Bimetal Dial Thermometers

### Bimetal Dial Thermometers for Industrial Applications

#### Typical Applications

- ➔ Oil, Gas & Petrochemical
- ➔ Food & Beverage
- ➔ Power Generation
- ➔ Waste Water
- ➔ Military
- ➔ Utilities
- ➔ Pharmaceutical
- ➔ Paper and Pulp
- ➔ Refrigeration
- ➔ Compost
- ➔ Dairy
- ➔ Marine
- and Many More !!!
- ➔ Mining

Bimetal Dial Thermometers are ideal for when you need a simple, "local" temperature display. Tempco offers 2 styles: Backmounted and Adjustable Angle, each available with either 3" or 5" dials.

#### Backmounted Bimetal Dial Thermometers

##### Design Features

- \* All Stainless Steel Construction
- \* Hermetically Sealed (ASME B40.3)
- \* Accurate to 1% of Full Scale
- \* Standard External Reset
- \* Silicone Fillable for Vibration Resistance
- \* 1/2" NPT Connection Standard
- \* Selected 3" and 5" Dial Thermometers Available from Stock

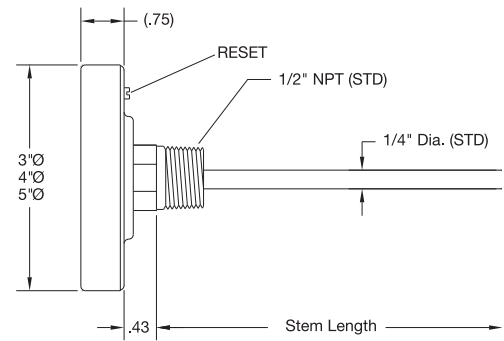

#### Backmounted Bimetal Dial Thermometers Standard Sizes and Ranges 1/2" NPT Connection Standard

Dial Dia. (in)	Stem Length (in)	Part Number by Temperature Range					
		-40 to 160°F	0 to 100°F	0 to 200°F	0 to 250°F	50 to 300°F	50 to 550°F
3	2.5	BMT10001	BMT10004	BMT10007	BMT10010	BMT10013	BMT10016
	4	BMT10002	BMT10005	BMT10008	BMT10011	BMT10014	BMT10017
	6	BMT10003	BMT10006	<b>BMT10009</b>	BMT10012	BMT10015	BMT10018
5	2.5	BMT10019	BMT10022	BMT10025	BMT10028	BMT10031	BMT10034
	4	BMT10020	BMT10023	BMT10026	BMT10029	<b>BMT10032</b>	BMT10035
	6	BMT10021	BMT10024	BMT10027	BMT10030	BMT10033	BMT10036

Stock Items Are Shown In RED

#### Adjustable Angle Bimetal Dial Thermometers

##### Design Features

- \* Complete 180° Adjustability
- \* 360° Case Rotation
- \* All Stainless Steel Construction
- \* Hermetically Sealed (ASME B40.3)
- \* Accurate to 1% of Full Scale
- \* Standard External Reset
- \* Silicone Fillable for Vibration Resistance
- \* 1/2" NPT Connection Standard
- \* Selected 3" and 5" Dial Thermometers Available from Stock

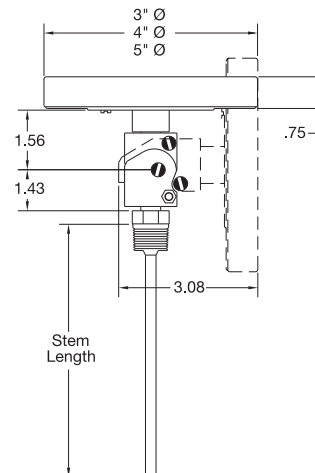

**CONTINUED** →



### Bimetal Dial Thermometers for Industrial Applications

Continued from previous page...

#### Adjustable Angle Bimetal Dial Thermometers Standard Sizes and Ranges 1/2" NPT Connection Standard

Dial Dia. (in)	Stem Length (in)	Part Number by Temperature Range					
		-40 to 160°F	0 to 100°F	0 to 200°F	0 to 250°F	50 to 300°F	50 to 550°F
3	2.5	BMT20001	BMT20004	BMT20007	<b>BMT20010</b>	BMT20013	BMT20016
	4	BMT20002	BMT20005	BMT20008	BMT20011	BMT20014	<b>BMT20017</b>
	6	BMT20003	BMT20006	BMT20009	BMT20012	BMT20015	BMT20018
5	2.5	BMT20019	BMT20022	BMT20025	BMT20028	BMT20031	BMT20034
	4	BMT20020	BMT20023	BMT20026	BMT20029	BMT20032	BMT20035
	6	*BMT20021	BMT20024	BMT20027	BMT20030	BMT20033	BMT20036

Stock Items Are Shown In **RED**

Ordering Code **BMT** -

#### Dial Diameter BOX 1

Standard: **3** = 3"  
**5** = 5"  
Special: **4** = 4"  
**9** = Other (Specify)

#### Temperature Scale BOX 5

Standard: **F** = Fahrenheit  
Special: **C** = Celsius  
**D** = Dual

#### Dial Mounting Style BOX 2

**A** = Adjustable Angle  
**B** = Back Mounted

#### Stem Length BOX 3

Whole inches + tenths  
Standard Stem Lengths are:  
**025** = 2.5"      **040** = 4"      **060** = 6"  
**090** = 9"      **120** = 12"

Note: For special order, lengths from 2.5" (025) to 80" (800) are available;  
Consult Tempco with your requirements.

#### Mounting/Fitting BOX 4

Standard: **1** = 1/2" NPT  
Special: **5** = 3/4" NPT adapter  
**U** = 1/2" NPT union (female conversion)  
**C** = 1-1/2" Sanitary Tri-Clamp  
**L** = 2" Sanitary Tri-Clamp  
**M** = 3/4" Sanitary Tri-Clamp

Others available; consult TEMPCO with your requirements.

#### Temperature Ranges BOX 6

Code	Fahrenheit	Celsius	Dual (°F & °C)
<b>Standard:</b>			
<b>23</b>	-40/160°F		
<b>35</b>	0/100°F		
<b>43</b>	0/200°F		
<b>47</b>	0/250°F		
<b>63</b>	50/300°F		
<b>67</b>	50/500°F		
<b>Special:</b>			
<b>23</b>		-40/70°C	-40/160°F & -40/70°C
<b>55</b>	25/125°F	0/50°C	25/125°F & -5/50°C
<b>43</b>		0/100°C	0/200°F & -10/90°C
<b>47</b>		-20/120°C	0/250°F & -20/120°C
<b>63</b>		10/150°C	50/300°F & 10/150°C
<b>67</b>		10/250°C	50/500°F & 10/250°C
<b>69</b>	50/550°F	10/300°C	50/550°F & 10/300°C
<b>81</b>	150/750°F	50/400°C	150/750°F & 70/400°C
<b>85</b>	200/1000°F	100/500°C	200/1000°F & 100/500°C

Others ranges available; consult Tempco with your requirements.

#### Special Options BOX 7

**PS** = Pointed Stem      **PC** = Acrylic Window  
**SF** = Silicone Fill      **PY** = Polycarbonate Window  
**SS** = 316 SS Stem      **TG** = Tempered Glass Window  
**F3** = 3/8" Stem Diameter      **MM** = Min/Max Pointer  
Consult Tempco with your requirements.

### Ordering Information

Bimetal Thermometers are offered with the options listed in the worksheet above. Create an ordering code by filling in the boxes with the appropriate number and/or letter designation for your requirements and a part number will be assigned. Part Numbers for commonly used Bimetal Thermometers can be found in table above.

Standard lead time is stock to 3 weeks.

**⚠ WARNING:** Cancer and Reproductive Harm - [www.P65Warnings.ca.gov](http://www.P65Warnings.ca.gov).

**(800) 323-6859 • Email: [sales@tempco.com](mailto:sales@tempco.com)**

## Digital Thermometers

### Handheld Digital Thermometers — Heavy Duty, Accurate

Type J or K Thermometers with single or dual input, with direct or differential measurements to 0.1°

#### Design Features:

- \* Rugged design for field use — includes rubber holster.
- \* Displays Maximum reading and Data Hold at the touch of a button.
- \* Single or dual input models available.
- \* Dual input model provides differential readings.
- \* Accurate to 0.3%, °F/°C switchable on the front panel.
- \* Includes: 9V battery, holster with stand, wrist strap and bead-style temperature probe.

All Items Available from Stock



DTM11010



DTM11020



DTM11030

#### Specifications

	DTM11010	DTM11020	DTM11030
<b>Thermocouple:</b>	Single Type K	Dual Type K	Dual Type J or K
<b>Temperature Range:</b>	-58° to 2000°F (-50° to 1300°C)		<b>J</b> -328° to 1922°F (-200° to 1050°C) <b>K</b> -328° to 2498°F (-200° to 1370°C)
<b>Basic Accuracy:</b>	± 0.3% of reading		± 0.05% of reading
<b>Display Counts:</b>	2000		20,000
<b>Resolution:</b>	0.1° / 1°		0.2°F / 0.1°C
<b>Dimensions:</b>	6.5" × 3" × 1.7" (165 × 76 × 43mm)		7.6" × 3.6" × 2.1" (192 × 91 × 53mm)
<b>Weight:</b>	14.2 oz (403g)		13 oz (365g)

### Temperature Probes – Thermocouple Type K

All probes shown come with 39" of cable and a mini-type plug.

#### DTA11015

- \* Surface Probe
- \* Straight Shaft
- \* 6" (152 mm) long Ceramic Tip
- \* Maximum Temperature: 932°F / 500°C



#### DTA11025

- \* Blunt-end Probe
- \* 4" (102 mm) long, 0.130" dia. rounded tip
- \* Type K T/C
- \* Maximum Temperature: 1292°F / 700°C



#### DTA11035

- \* Piercing-end Probe
- \* 4" (102 mm) long, 0.130" dia. rounded tip
- \* Type K T/C
- \* Maximum Temperature: 1472°F / 800°C

